

FH-SHB Flat Head Semi-Hex Body

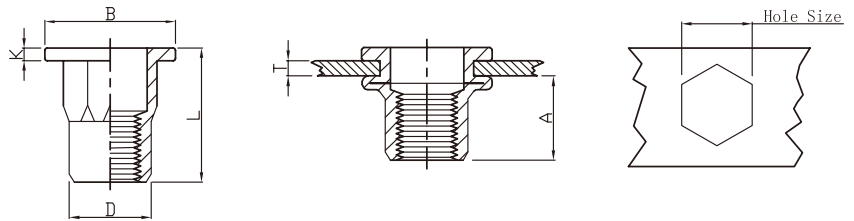

UNIT : mm

Thread	P/N	T(GRIP RANGE)		A Rer	Hole Size $+0.1$ 0	D $+0.07$ -0.1	B	K	L
		Min	Max						
M4	FH-SHB-0420	0.5	2.0	6.5	6.0	5.9	9.0	0.8	11.0
M5	FH-SHB-0525	0.5	2.5	8.0	7.0	6.9	10.0	1.0	13.0
M6	FH-SHB-0630	0.5	3.0	8.5	9.0	8.9	12.7	1.35	15.0
M8	FH-SHB-0835	1.0	3.5	10.5	11.0	10.9	16.0	1.5	18.0
M10	FH-SHB-1035	1.0	3.5	12.5	13.0	12.9	18.0	1.7	21.0
M12	FH-SHB-1240	1.0	4.0	14.0	15.0	14.9	20.0	1.7	23.0
M10	FH-SHB-1035(12H)	1.0	3.5	11.0	12.0	11.9	17.0	1.6	19.0
M12	FH-SHB-1250(16H)	2.0	5.0	16.5	16.0	15.9	23.0	2.2	27.5

FH-SHBC Flat Head Semi-Hex Body Close End

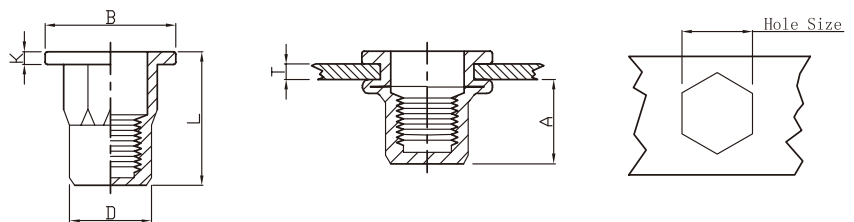

UNIT: mm

Thread	P/N	T(GRIP RANGE)		A Rer	Hole Size $+0.1$ 0	D $+0.07$ -0.1	B	K	L
		Min	Max						
M4	FH-SHBC-0420	0.5	2.0	11.0	6.0	5.9	9.0	0.8	15.0
M5	FH-SHBC-0525	0.5	2.5	13.5	7.0	6.9	10.0	1.0	18.0
M6	FH-SHBC-0630	0.5	3.0	17.0	9.0	8.9	12.7	1.3	23.0
M8	FH-SHBC-0835	1.0	3.5	19.0	11.0	10.9	16.0	1.5	26.0
M10	FH-SHBC-1040	1.0	4.0	25.0	13.0	12.9	19.0	1.7	33.0

FH-FHB Flat Head Full Hex

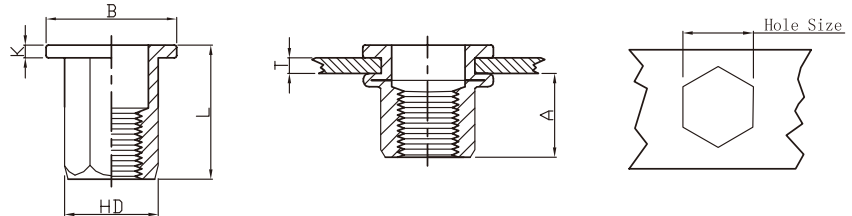

UNIT: mm

Thread	P/N	T(GRIP RANGE)		A Rer	Hole Size $+0.1$ 0	HD $+0.07$ -0.1	B	K	L
		Min	Max						
M4	FH-FHB-0420	0.5	2.0	6.5	6.0	5.9	9.0	0.8	11.0
M5	FH-FHB-0525	0.5	2.5	8.0	7.0	6.9	10.0	1.0	14.0
M6	FH-FHB-0630	0.5	3.0	8.5	9.0	8.9	12.7(*13.0)	1.35	15.0(*16.0)
M8	FH-FHB-0835	1.0	3.5	10.5	11.0	10.9	16.0	1.5	18.0
M10	FH-FHB-1035	1.0	3.5	12.5	13.0	12.9	18.0(*19.0)	1.7	21.0(*23.0)
M12	FH-FHB-1240	1.0	4.0	14.0	15.0	14.9	20.0	1.7	23.0
M10	FH-FHB-1035(12H)	1.0	3.5	13.5	12.0	11.9	18.0	1.7	21.0
M12	FH-FHB-1250(16H)	2.0	5.0	16.5	16.0	15.9	23.0	2.0	27.0

※Part are different series, if customer need this size, please mark.

FH-FHBC Flat Head Full Hex Body Close End

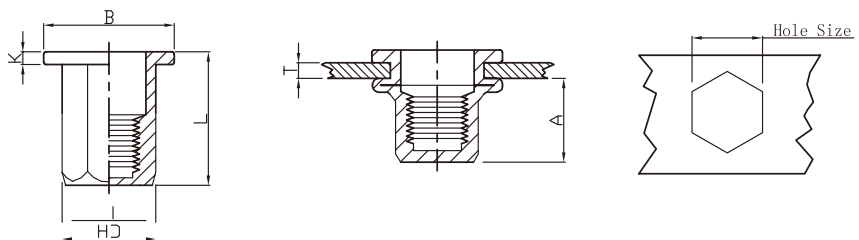

UNIT: mm

Thread	P/N	T(GRIP RANGE)		A Rer	Hole Size $+0.1$ 0	HD $+0.07$ -0.1	B	K	L
		Min	Max						
M4	FH-FHBC-0420	0.5	2.0	11.0	6.0	5.9	9.0	1.0	15.0
M5	FH-FHBC-0525	0.5	2.5	13.5	7.0	6.9	10.0	1.0	18.0
M6	FH-FHBC-0630	0.5	3.0	17.0	9.0	8.9	12.7	1.5	23.0
M8	FH-FHBC-0835	1.0	3.5	19.0	11.0	10.9	16.0	1.5	26.0
M10	FH-FHBC-1040	1.0	4.0	25.0	13.0	12.9	19.0	2.0	33.0

RHH-FHB Reduce Hex Head Full-Hex Body

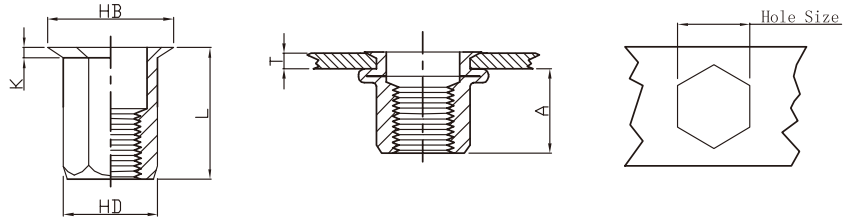

UNIT: mm

Thread	P/N	T(GRIP RANGE)		A Rer	Hole Size +0.1 0	HD +0.07 -0.1	HB	K	L
		Min	Max						
M4	RHH-FHB-0425	0.5	2.5	6.7	6.0	5.9	7.0	0.5	11.0
	RHH-FHB-0450	2.5	5.0						13.5
M5	RHH-FHB-0530	0.5	3.0	9.0	7.0	6.9	8.0	0.5	14.5
	RHH-FHB-0550	3.0	5.0						16.0
M6	RHH-FHB-0635	1.0	3.5	10.0	9.0	8.9	10.0	0.6	16.0
	RHH-FHB-0660	3.5	6.0						18.0
M8	RHH-FHB-0840	1.0	4.0	11.5	11.0	10.9	12.0	0.65	18.0
	RHH-FHB-0860	4.0	6.0						20.0
M10	RHH-FHB-1035	1.0	3.5	12.5	13.0	12.9	14.5	0.75	19.0
	RHH-FHB-1060	3.5	6.0						23.5

M12. M12 is available

RHH-FHBC Reduce Hex Head Full-Hex Body Close End

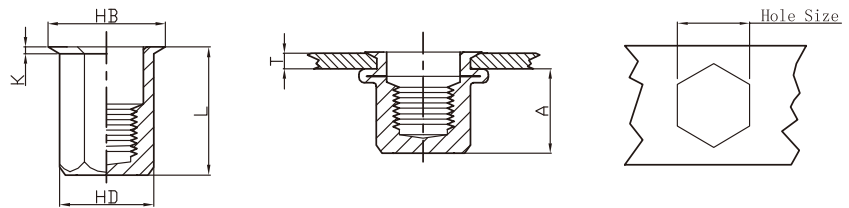

UNIT: mm

Thread	P/N	T(GRIP RANGE)		A	Hole Size +0.1 0	HD +0.07 -0.1	HB	K	L
		Min	Max						
M4	RHH-FHBC-0425	0.5	2.5	12.3	6.0	5.9	7.0	0.5	16.0
M5	RHH-FHBC-0530	0.5	3.0	15.2	7.0	6.9	8.0	0.5	20.0
M6	RHH-FHBC-0635	0.5	3.5	14.5	9.0	8.9	10.0	0.6	20.5
M8	RHH-FHBC-0840	1.0	4.0	17.0	11.0	10.9	12.0	0.65	23.0
M10	RHH-FHBC-1045	1.0	4.5	20.0	13.0	12.9	14.5	0.75	28.5

RHH-IHB Reduce Hex Head Inner-Hex Body

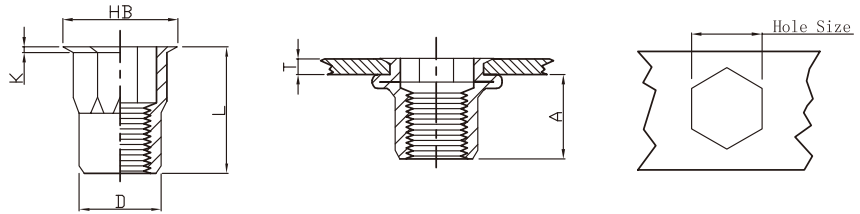

UNIT(单位): mm

螺纹 Thread	编号 P/N	T(GRIP RANGE)		A Rer	Hole Size $+0.1$ 0	D $+0.07$ -0.1	HB	K	L
		Min	Max						
M4	RHH-IHB-0420	0.5	2.0	8.3	6.0	5.9	7.0	0.5	12.0
M5	RHH-IHB-0525	0.5	2.5	8.7	7.0	6.9	8.0	0.5	13.0
M6	RHH-IHB-0635	1.0	3.5	10.5	9.0	8.9	10.0	0.6	16.0
M8	RHH-IHB-0835	1.0	3.5	11.3	11.0	10.9	12.0	0.65	17.5
M10	RHH-IHB-1040	1.0	4.0	12.8	13.0	12.9	14.5	0.75	21.0

FH-IHB Flat Head Inner-Hex Body

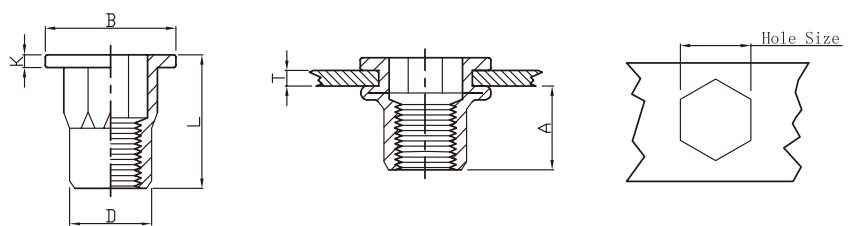

UNIT: mm

Thread	P/N	T(GRIP RANGE)		A Rer	Hole Size $+0.1$ 0	D $+0.07$ -0.1	B	K	L
		Min	Max						
M4	FH-IHB-0420	0.5	2.0	7.0	6.0	5.9	9.0	0.8	11.0
M5	FH-IHB-0525	0.5	2.5	7.5	7.0	6.9	10.0	1.0	12.0
M6	FH-IHB-0630	0.5	3.0	9.2	9.0	8.9	12.7	1.3	15.5
M8	FH-IHB-0835	1.0	3.5	11.2	11.0	10.9	16.0	1.5	18.0
M10	FH-IHB-1035	1.0	3.5	12.8	13.0	12.9	18.0	1.7	21.0